

Please read the instructions
before assembly!

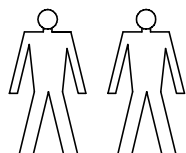

Mounting tools that the customer needs:



20 min

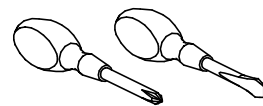
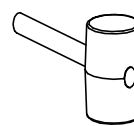
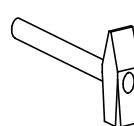

PORTO

Important information:

1) remove
the protective foil if
the table is in high gloss

2) Add more elements for
the coffee table to
be higher

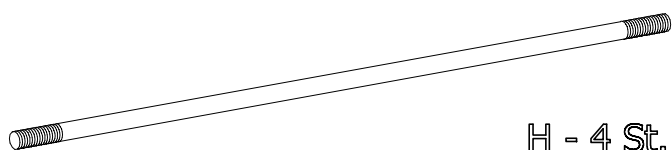
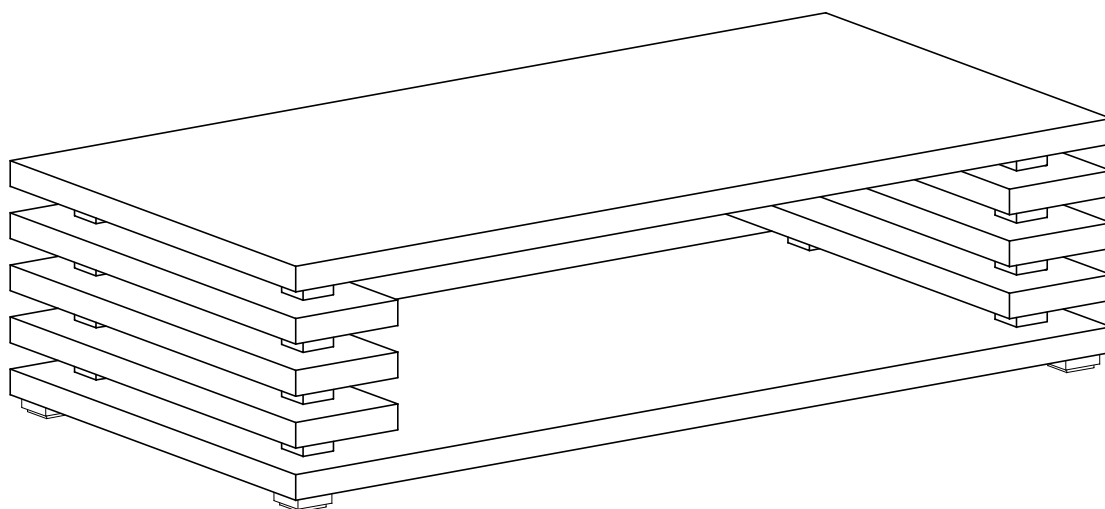
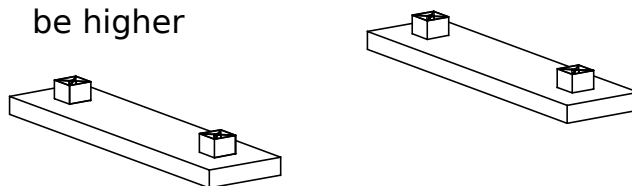

H - 4 St.

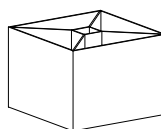

G - 16 St.

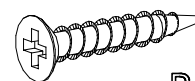

R - 16 St.
4 x 30 mm

B - 4 St.

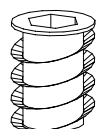

F - 4 St.

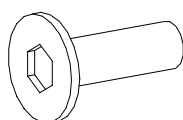

P - 4 St.

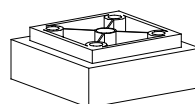

16

